

ZG-projekt

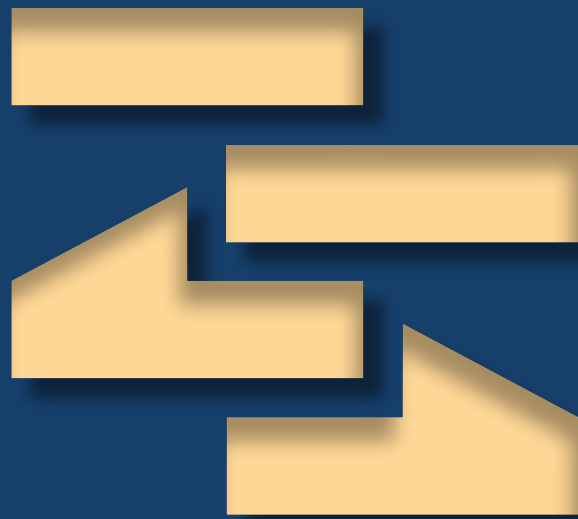

references

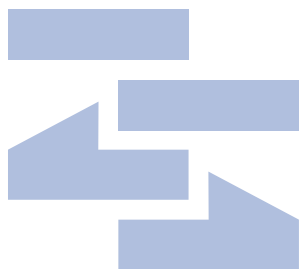

ZG-projekt

d.o.o. for design and surveillance

ZG-PROJEKT d.o.o. is a company founded in 1993 and it specializes in design and surveillance. The company has a total of more than twenty employees, experts in the fields of civil engineering, traffic, electrical engineering, mechanical engineering and architecture. Beside projects within the Republic of Croatia, Zg-Project has successfully worked in other – neighboring countries such as: Bosnia and Herzegovina, Serbia and Montenegro. Due to high quality performance and excellent working ethics, ZG-PROJEK can satisfy any and all requirements as well as its clients and partners demands whether in Croatia or abroad.

Highways



Traffic lights

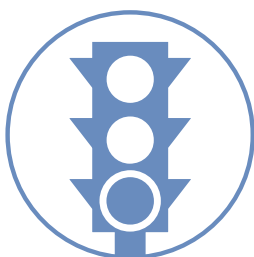

Tunnels



Architectural projects



Certificates:

ISO 9001:2008

ISO 14001:2004

OHSAS 180001:200



Content

- 3 Sadržaj
- 4 Basic activities
- 6 Traffic and technical project
- 10 Civil engineering projects
- 12 Architectural projects
- 13 Development of urban and detailed urban spatial plans
- 14 Geodesy
- 15 Traffic studies
- 16 Projects of construction
- 18 Algorithms and Scenarios
- 19 Traffic lights
- 21 Street lights
- 22 Guidelines and Croatian Standards
- 23 Sanation of dangerous sites
- 24 International projects
- 25 Expert designer monitoring and surveillance
- 26 Energy certification
- 27 Investments



Basic activities



Projects of traffic equipment and signalization for: highways, expressways, county and state roads



Civil engineering projects



Architectural projects



Street lighting



Studies of scenarios and algorithms of regular activities, including expected breakdowns, incidental situations and ordinary maintenance for the Centre for maintenance and traffic monitoring in tunnels



Traffic studies



Traffic lights studies



Projects of construction of toll payment stops and border crossings and payment processing for tolls



Land survey services



Concept design, designing project, final design and the design for construction



Compilation of standards and guidelines



Elaboration of sanitation project for dangerous point within roads



Elaboration of international project designing for roads



Expert and designer monitoring



Studies



Project planning



Investment projects



Expert opinions and consulting



Conducting energy audits and energy certification of residential and non-residential buildings



Nostrification preliminary, main and detailed design produced abroad (architectural, construction and electrical engineering)



Legalization of the structures

Traffic and technical project



design of highways, express ways, state roads and any other roads

Traffic – technical projects define the traffic signalization and the road equipment as well as the traffic regulation on certain routes of highways, express ways, state roads and any other roads. Project documentation includes the details regarding the solution for signalization, road and intersection equipment, as well as the description and the details regarding the facilities and other objects within the road, the intersections with existing roads, remote traffic

regulation, cable canalization and electricity supply for the traffic information system, all the bearing structures of traffic signalization, the system of remote control and monitoring and the LAN networks, the architecture and the solution of the traffic signalization of toll ways and their connection into the payment processing system, the centres for traffic maintenance and control, corresponding service facilities, temporary traffic regulation.

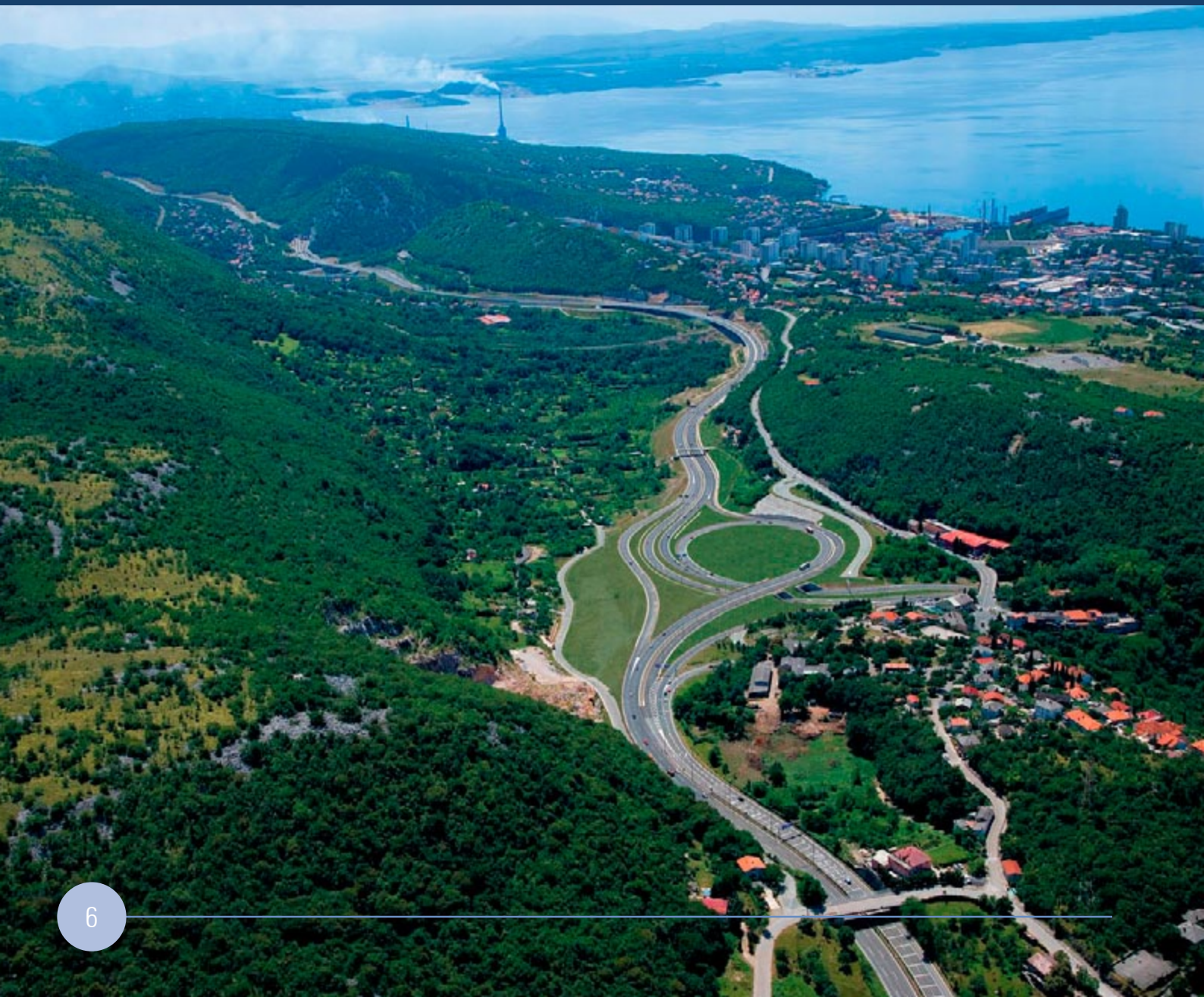



HIGHWAYS

Highway (HW) A1 Zagreb – Split – Dubrovnik (374,03km)

- route Karlovac – Zagreb [38,58 km]
- sector Bosiljevo – Saint Rok [143,43 km]
- sector Saint. Rok – Zadar II [52,75 km]
- sector Dugopolje – Zagvozd [111,77 km]
- sector Zagvozd – Ploče [27,5 km]
- sector Doli – Dubrovnik
- tunnels on the route: Mala Kapela [5,801 km], Grič [1,244 km], Plasina [2,3 km] and Brinje [1,561 km]
- toll ways: Lučko, Donja Zdenčina, Jastrebarsko, Novigrad, Bosiljevo, Ogulin, Brinje, Otočac, Perušić, Gospić, Gornja Ploča, Sveti Rok, Maslenica, Posedarje, Zadar 1, Zadar 2, Pirovac, Skradin, Šibenik, Vrpolje, Prgomet, Vučevica, Dugopolje, Bisko, Blato na Cetini, Ravča Karamatići
- toll payment systems on toll ways
- reconstruction of the access to the toll payment stop Lučko from the direction of Karlovac
- centre for traffic control and maintenance (COKP): Plasina, Mala Kapela, Dugopolje, Zagvozd, Vrgorac
- corresponding service facilities PUO Zdenčina-zapad, PUO Desinec, PUO Dobra, PUO Modruš, PUO Jezerane, PUO Brinje, PUO Brloška Dubrava, PUO Ličko Lešće, PUO Janjče, PUO Lički Osik, PUO Zir, PUO Jasenice, PUO Mosor, PUO Kotlenica, PUO Župa
- architectonics: PČCP Zemunik Gornji, CP Vrpolje, CP Bisko, CP Šestanovac, PUO Kotlenica i PUO Mosor, proširenje ČCP Lučko along with three new passages and the construction of a parking lot counting 81 parking spot
- temporary regulation of traffic during the period of construction of certain sections of the highway
- connection roads for intersections and existing traffic roads

HW A2 Zagreb – Macelj (40,63km)

- route intersection Jankomir – čvor Zaprešić [7,4 km]
- route Krapina – Macelj [33,23 km]
- toll ways: Zaprešić, Gubaševo, Začretje, Krapina, Đurmanec, Trakošćan
- temporary regulation of traffic during the period of construction of certain sections of the highway
- parallel road

HW A3 Bregana – Zagreb – Lipovac (208,4km)

- route Velika Kopanica – Županja [25,95 km]
- route Županja – Lipovac [29,43 km]
- sector ČCP Ivanja Reka – Velika Kopanica [208,4 km]
- intersections: Kosnica, Rugvica
- toll ways: Bregana, Ivanja Reka, Rugvica, Ivanić Grad, Križ, Okučani, Slavonski Brod – Zapad, Slavonski Brod – Istok, Babina Greda, Županja, Spačva, Lipovac
- toll payment systems on toll ways
- management of traffic for ENC users at the toll payment stop Ivanja Reka
- centre for traffic control and maintenance (COKP): Ivanja Reka, Kutina, Okučani, Slavonski Brod, Županja
- corresponding service facilities PUO Gradna
- architecture: reconstruction ČCP Ivanja Reka
- temporary regulation of traffic during the period of construction of certain sections of the highway
- connection roads from intersections to the existing roads (connection point Babina Greda – to the existing road D520)

HW A4 Zagreb – Goričan (96,9km)

- sector Ivanja Reka – border with Hungary [96,9 km]



- Toll ways: Sveta Helena, Komin, Breznički Hum, Novi Marof, Varaždinske Toplice, Varaždin, Ludbreg, Čakovec, Goričan,
- regulation of goods traffic
- corresponding service facilities PUO Varaždin, PUO Novi Marof
- temporary regulation of traffic during the period of construction of certain sections of the highway
- connection roads for intersections and existing traffic roads

HW A5 Beli Manastir – Osijek – Svilaj (88 km)

- sector Beli Manastir – Sredanci [88 km]
- Toll ways: Velika Kopanica, Đakovo Osijek
- toll payment systems on toll ways
- centres for traffic control and maintenance (COKP): Đakovo, Čepin
- corresponding service facilities PUO Andrijeveci, PUO Ivandvor, PUO Beketinci, PUO Strossmayerovac, PUO Baranja, PUO Mursa
- temporary regulation of traffic during the period of construction of certain sections of the highway
- connection roads for intersections and existing traffic roads

HW A6 Bosiljevo – Rijeka (81,2 km)

- route Orehovica – Kikovica – Oštrovica
- sector Kupjak – Oštrovica
- tunnels: Vršek [856 m], Tuhobić [2141 m]
- Toll ways: Bosiljevo, Vrbovsko, Ravna Gora
- surveillance system designed to monitor the traffic of vehicles carrying dangerous cargo on the highway
- recognition system for licence plates and integration into the charging system



- management of traffic for ENC users at the toll payment stop Lučko
- height control for vehicles on access roads of: Lučko, Jastrebarsko, Karlovac, Bosiljevo I, Vrbovsko, Ravna Gora, Delnice, Vrata, Oštrovica, Grobnik
- corresponding service facilities PUO Tuhobić
- temporary regulation of traffic during the period of construction of certain sections of the highway
- connection roads for intersections and existing traffic roads

HW A7 Rupa – Žuta Lokva (81 km)

- sector Jurdani – border with Slovenia [11 km]
- sector Križišće – Žuta Lokva [56 km]
- route Orehovice – Dv. Kuzam – Križišće [14 km]
- Toll ways: Rupa
- centres for traffic control and maintenance (COKP): Rupa
- corresponding service facilities PUO Rupa
- temporary regulation of traffic during the period of construction of certain sections of the highway

HW A8 Istarski Y (16,53 km)

- route Rogovići – Kanfanar [16,53 km]
- tunnels: Učka [5,062 km]
- toll ways: intersection Vranja: Lupoglavlje, Cerovlje, Ivoli, Rogovići, Žminj, Kanfanar
- temporary regulation of traffic during the period of construction of certain sections of the highway

HW A9 Istarski Y (71,49km)

- sector Umag – Bale [57,82 km]
- route Vodnjan – Pula [13,67 km]
- intersection Kanfanar
- Toll ways: Vodnjan, Medaki, Mirna
- temporary regulation of traffic during the period of construction of certain sections of the highway

HW A10 Border crossing with Bosnia and Herzegovina – Mali Prolog – Ploče (6,5km)

- sector Mali Prolog – Čvor Ploče – Border with BIH [6,5 km]
- temporary regulation of traffic during the period of construction of certain sections of the highway
- connection roads for intersections and existing traffic roads

HW A11 Zagreb – Sisak (10,80 km)

- route Lekenik – Sisak [10,80 km]
- intersection Stupno
- Toll ways: Sisak
- toll payment systems on toll ways

HW A12 Sv. Helena – Vrbovec – Koprivnica, (30,50 km)

- route: Gradec-Velika Mučna [30,50 km]
- subroute: Gradec – Kloštar
- traffic– technical projects of the highway
- architectural projects for high-rise buildings

HW A13 Vrbovec 2 – G.P. Terezino Polje (27,53 km)

- route Vrbovec 2 – Bjelovar [27,53 km]

New beltway for Zagreb (106 km)

I. Route: Luka – Horvati

- traffic and IT projects, installation and tunnel equipment
- providing the architectural solution and the full equipment for the buildings – objects on the highway

II. Route : Horvati – Ivanić Grad

- traffic equipment and signalization projects
- reconstruction of the intersection Lučko

III. Route: Ivanić Grad – Zelina

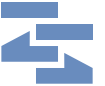

- traffic and traffic-information projects, installations and tunnel equipment
- providing the architectural solution and the full equipment for the buildings – objects on the highway

EXPRESS WAYS

Express way Udbina – Gornja Ploča [6,2 km]

Express way Mostanje – V. Cerovac [6,1 km]

Express way Šibenik – Drniš – Knin – Border crossing with Bosnia and Herzegovina (BiH) [4,9 km]

- route Šibenik – Tromilja; subroute intersection Ražine – Dubrava

Express way Stobreč – Omiš

- route Stobreč – Dugi Rat [9,9 km]
- subroute Grljevac – Dugi Rat [4,2 km]

Express way Vrbovec – Bjelovar

- from km 6+250,00 to km 27+530,00 (stage 2, 3, 4 i 5)

STATE ROADS

State road D1

- connection to the industrial zone Kukuruzovac to the state road D1

State road D3

- section D. Puštakovec – Štefanec

State road D6

- route Netretić – Lišnica; part 1 Netretić – intersection Novigrad [10,5 km]

State road D8

- route Orešnica – Draga – Sv. Kuzam/Bakar [6,4 km]
- sector Saint. Kuzam – Križišće [9 km]
- sector Solin – Plano [15,3 km]
- route Solin – Kaštel Sućurac; temporary traffic regulation during reconstruction [4,3 km]

State road D10

- Section Gradec – Križevci (12 km)

State road D24

- Section Zl.Bistrica – Galovec

State road D29

- Section N. Golubovec – Zl.Bistrica (civil engineering design, traffic and installation design)

State road D32

- reconstruction of the state road sub-route Crni Lug – Malo Selo – temporary traffic regulation during reconstruction works

State road D39

- route Zadvarje – Vukušići [5,6 km]

State road D41

- reoute Sv. Helena – Gradec; overpass Grabrić

State road D43

- regulation of traffic nearby the rural tourism facility of the Kezele family
- diversion of the D43 towards the zone 3 (plant Kraš)
- diversion of the D43 towards the zones 4 and 5 (Šiftarova Street)
- diversion of the D43 towards the zone 6

State road D102

- temporary regulation of traffic during the construction works on the bridge Krk

State road D410

- route 001 Split ferry port – Split D8; intersection D410 and Velebitska street

State road D 518 Osijek – Gaboš – Jarmina

- route Ada – Jarmina [15 km]

State road D532 Zagvozd – Baška Voda

- tunnel Sv. Ilija (Biokovo)
- access road to the Northern portal of the tunnel [8 km]
- access road to the Southern portal of the tunnel

Remote traffic regulation on the State roads

- intersections: Posedarje 1 Posedarje 2, Posedarje 3, Obrovac, Zadar 1, Poličnik, Islam Latinski, Biljane Donje, Šopot, Benkovac 1, Benkovac 2, Kruševo, Pridraga, Zaton Obrovački, Gračac 1, Gračac 2, Josipdol 1, Josipdol 2, Skradin, Karin, Karlovac, Stara Straža, Knin centar, Split – luka, Knin sjever, Sinj, Klis, Udbina, Split – Bilice, Split – Domovinskog rata, Biograd na moru, Dubrava kod Pirovca, Brnaze, Bruvno, Osoje, Korenica, Borje, Prijeboj, Ličko Petrovo Selo, Rastovača, Grabovac, Krmjak, Brezova Glava, Krapina, Đurmanec, Donji Macelj, Sučevići, Lički Osik, Sinj 2, Gospić 1, Gospić 2, Šibenik – Bilice, Šibenik – Ražine, Čovići, Otočac, Senj – sjever, Senj – centar, Bosanci, Žuta Lokva, Seget Donji, Bribirske Mostine, Varivode, Lozovac, čvor Čavle, čvor Orešnica, čvor Škurinje, rotor Novi Marof

Direction signalization on remote intersections of the county of Istra

Intersection railway and state road

- railway Oštarije – Knin – Split; route Perušić – Gračac; sub-route bridge Jaruga – Gračac

COUNTY ROADS

- intersection state roads 3041 and 3074 in Kloštar Ivanić
- relocation of the county road Ž5062
- out of ordinary maintenance of county roads (CR) 3070 [4,0 km], CR 3016 [3,0 km]

CITY ROADS

Samobor

- Tourist traffic signs and signals

Access Terminal of the Ploče Port

Solin

- Mravinci ramps in Solin [0,5 km]

Elaborat of the temporary traffic regulation on railroad crossings

- crossings: Graboštani, Bročice, Dobrovac, Lipik, Volinje, Čukur, N.Subocka, Majur, Ivanić Grad, Hrastovec, Vedro Polje, Četvrtkovec, Sunja, Hrvatska Kostajnica, Stupno, Križ, Kurilovec, Velika Gorica, Pojatno, Popovača

Zagreb

- Peščenica north residential-business object – K9

Civil engineering projects



Civil engineering projects entail project design for reconstruction or renewal of roads, as well as the design of adequate infrastructure and accompanying objects.

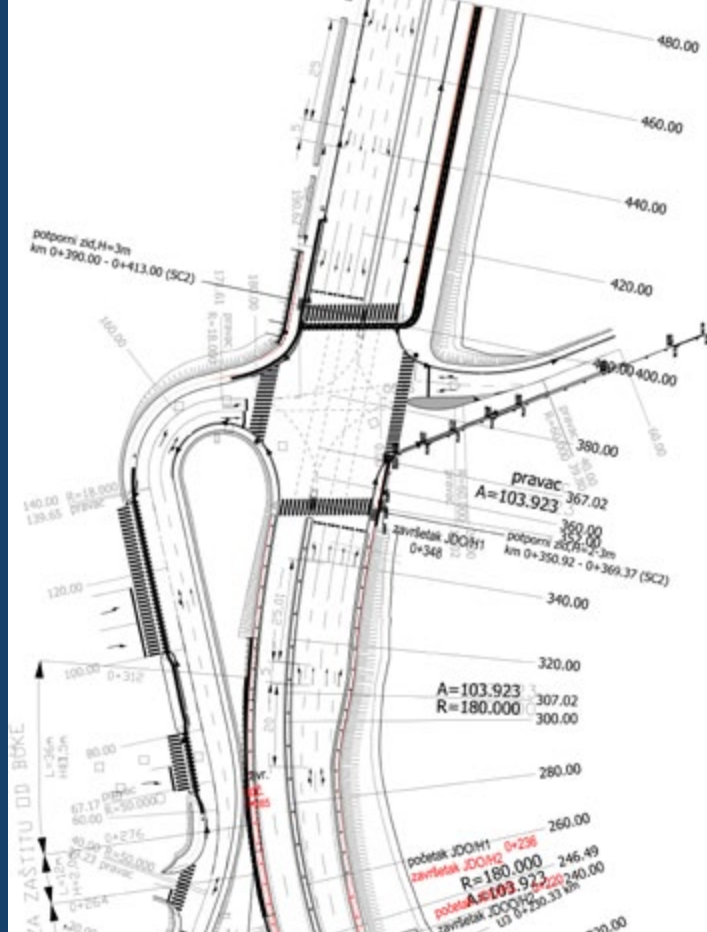

HW A2 Zagreb – Macelj: junction “Bistra”

- Idea project of new junction and obtaining location permit
- Main project
- Detailed project

State road D29, Section Novi Golubovec – Mače – Marija Bistrica (30 km)

- Reconstruction of state road and obtaining location and building permit

State road D35, Section Novi Golubovec

- Reconstruction of state road and obtaining location and building permit

Expressway Popovec – Marija Bistrica – Zabok

- With access road on Breznički Hum, section Popovec – Kašina (6km)
- Amendments of location permit, all main projects, geodesy and geotechnical inquisitional works

Bridge over Sava – Odra canal with access road

- Main and detailed design
- Obtaining building permit

Roundabout in Sv. Helena

- Main and detailed design
- Roundabout in Pođundek
- Designs and administrative procedure

HW service facility Križ north/south

- Designs and administrative procedure

HW service facility Zamet

- Designs and administrative procedure

Broadening of ČCP Lučko and parking lot construction

PČCP Županja phase II

Gas Station Čepin

County Roads (CR) 3070 4,0 km & CR 3016 3,0 Km

- out of ordinary maintenance

Krašić Bridge

State road 29 Novi Golubovec – Mače – Marija Bistrica

- reconstruction of state road, location and building permit

Popovača

- bus station in Popovača

Ivanić Grad

- reconstruction of city roads Krešimir IV; Pokupska; Maznica
- reconstruction of Lonjska street
- reconstruction of Vukovarska, designing of sewage system
- intersection of state road D43 and Majdekova LC3117
- diversion of the D43 towards zone 3 (plant Kraš)
- diversion of the D43 towards zone 5 and zone 4 (diversion past the gas station before the overpass – Šitarova street extension)
- diversion towards zone 6
- roundabout on the intersection of Vulinčeva and Etanska

- roundabout on the intersection of Savska and Industrijska
- roundabout on the intersection of Omladinska and Ulica Slobode
- D43, Franje Jurinca and Etanska
- UPU-3, business zone in the Ivanić-Grad area,
- UPU-6, business zone in the Ivanić-Grad and Caginec area

Samobor

- reconstruction of city roads, intersection street A. Starčević – Betonska street

Local road Velika Gorica – Jagodno

- Bus stop Novo Čiče

Local road Klara – Lukavec

- bus stop Lukavec

Velika Gorica

- expansion of the intersection of S. Kolar Streets and Zagrebačka Street
- Pedestrian way Velika Gorica
- Modernization of the road Vrpolje – Perković

Šibenik

- reconstruction of the technological road with an artificial tunnel and a retail storey within the train station

Sesvetski Kobiljak

- reconstruction of the streets Bjelovarska, Popovečka and Kvarnerska



Sv. Nedelja

- Temporary access road for the building site of the business park 'Zagreb'

Virovitica

- Redirecting cargo carrying vehicles within the city of Virovitica

Highway A3 Bregana – Zagreb – Lipovac

- part of building junction Novska – renovation of overpass construction of temporary entry/exit

Sisak

- shopping centre 'Baumax'; part of the construction works Connection to the Zagrebačka Street

County road Ž 4100, Požega – Lipovac

- route Požega – G. Vrhovci

Intersection county road Ž5182 and D8 – Jablanac

- Reconstruction of pavement and intersection, parcellation, obtaining location and building permit

County road Ž2231

- Reconstruction, obtaining location permit

County road Ž1036 Hrašćica – Sop

- Detailed design

County road Tounj

- Idea project and obtaining location permit

Local road LC31099 Malogorička road

- Reconstruction, obtaining location and building permit

County of Đulovac

- Modernisation and asphalt laying of non classified roads within Đulovac – A. Stačevića Street
- Modernisation and asphalt laying of non classified roads: Mali Bastaji, Bana Josipa Jelačića, Katinac, Miletinac, Koreničani, Vukovje, Škodinovac
- Sewage system in the County

Caginec

- Gas station on the state road D43

County of Križ

- Auxilliary road and all the corresponding infrastructure

Lučice nearby Delnice

- Business area K3: access roads along with communal infrastructure

Velika Mlaka

- Smendrovićeva Street (starting from Kovači Street until the planned circumference street)
- Kovači Street (starting from Smendrovićeva Street until Cavtatska)

Zagreb

- Odra, point of sale and service centre for Toyota
- Puškarićeva – Ježdovečka – project alteration
- Reconstruction of a part of the service road – access road to the shopping centre 'Metro' in Jankomir
- traffic areas of the parking lot of the Dubrava hospital

Bridge shore – Pelješac

- Access road – Brijesta

Bregana Pisarovinska

- relocation of a part of the county road Ž1037

Karlovac

- Smičiklasova street ; state road D1 route 010, intersection Karlovac – Krnjak on the km 3+000,00

Dugo Selo

- out of the ordinary maintenace of a part of county road ŽC 3070; route: junction Rugvica-Dugo Selo

Sv. Helena

- out of the ordinary maintenance of a part of county road ŽC 3016 from the intersection with ŽC 3278 (Soblinec-Blažev Dol) to Sv. Helena

Gubaševo

- Billboard "Belina"





Architectural projects

Architectural projects define the functional, technical, economic and formal components of art space design.

Job description of the architectural design of buildings includes activities related to the construction, reconstruction and maintenance.

Construction of the architectural design of buildings contain 8 main stage production.

1. Checking the task
2. Preliminary Design
3. Conceptual Design
4. location permit
5. The main project
6. Building permits
7. Detailed Design
8. Bill of quantities



Zagreb City “Civitas Elan”

- Study for arranging train station Remetinec

Underground gas storage Okoli

- conceptual , main and detailed design with obtaining location and construction permits for the construction of a new business building and warehouse
- professional supervision of the works

Special Hospital “Naftalan”

- preliminary architectural project of upgrading existing Special Hospital for Medical rehabilitation and complex of indoor and outdoor swimming pool with necessary traffic infrastructure

Plinacro Company

- design of prototype for the business premises

Detailed Plan of Business Zone Velika Ludina

HW A12 Sv. Helena – Vrbovec – Koprivnica

- route: Gradec-Velika Mučna
- subroute: Gradec – Kloštar
- architectural projects for high-rise buildings
- toll booth islands
- toll booth canopy
- toll payment facility
- architectural design

HW A13 Vrbovec 2 – G.P. Terezino Polje

- route Vrbovec 2 – Bjelovar
- architectural projects for high-rise buildings
- toll booth islands
- toll booth canopy
- toll payment facility
- architectural design

New beltway for Zagreb

I. Route: Luka – Horvati

- providing the architectural solution and the full equipment for the buildings – objects on the highway

II. Route : Horvati – Ivanić Grad

- reconstruction of the intersection Lučko

III. Route: Ivanić Grad – Zelina

- providing the architectural solution and the full equipment for the buildings – objects on the highway



Development of urban and detailed urban spatial plans

Performing all professional activities of drafting spatial planning documents and drafting reports on the subject area, and performing activities that include preparing and developing spatial planning documents.

Spatial plans, including their compilation and development, implementation of spatial plans, adaptation of the construction site, property institutes for the adaptation and supervision of the construction sites. Spatial plans ensure conditions for the use, protection and management of areas of the Republic of Croatia as a particularly valuable and limited national asset. This ensures the condition for social and economic development, environmental protection, high quality of building and rational use of natural and cultural assets.

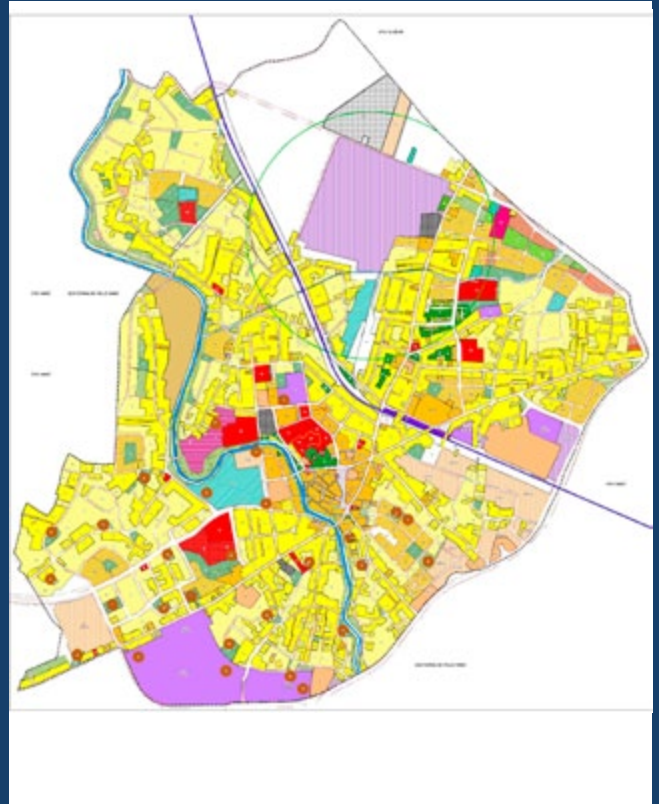

Ivanić-Grad

- Development of specific amendments of the spatial plan for Ivanić-Grad
- Development of specific amendments of the spatial plan for Ivanić-Grad (including reconstruction, upgrading and rehabilitation of the railroad M103 Dugo Selo – Novska)
- textual and graphic parts of the Plan were amended
- Development of the II. Amendments of the spatial plan for the city Ivanić-Grad
- I. Amendments to the Urban spatial plan UPU-3 of the zone for economic purposes in the area of Ivanić-Grad
- III. Amendments to the Urban spatial plan UPU-4 for the area of Ivanić-Grad, Šarampov and Jalševac Breški
- I. Amendments to the Urban spatial plan UPU-5 for the area of Donji Šarampov
- I. Amendments to the Urban spatial plan UPU-6 zone for economic purposes in the area of Ivanić-Grad and Caginec
- Revocation of the Detailed spatial plan DPU-1 historical center of Ivanić-Grad City of Zaprešić

City of Zaprešić

- Development of III. specific amendments of the spatial plan for the City of Zaprešić
- Development of the II. Amendments to the spatial plan for Shopping city Zagreb



Geodesy



Performing professional geodetic activities in the field of state survey, real estate cadastre and line cadastre, professional geodetic activities for the needs of spatial planning and construction, professional geodetic activities for the needs of consolidation of agricultural land, professional geodetic activities for the needs of protected areas, other professional geodetic activities performed as services to physical and legal entities.

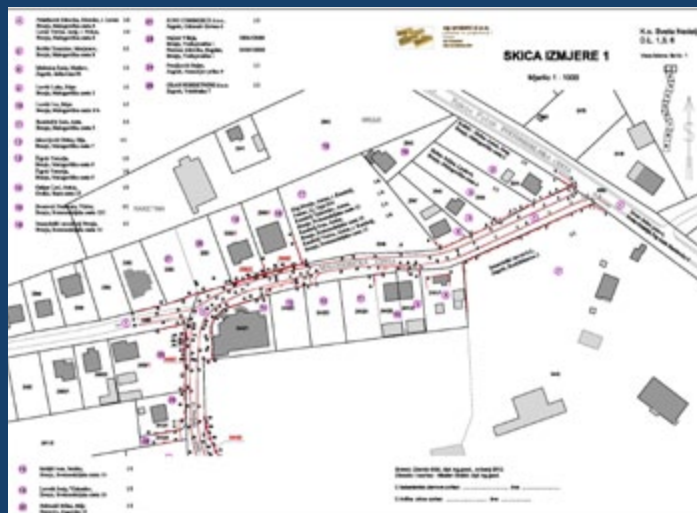

COUNTY ROADS ADMINISTRATION OF ZAGREB COUNTY

Bridge over Sava – Odra canal with access road (2012)

- Main and detailed design, Obtaining building permit
- development of specific geodetic basis for the purpose of developing documents and acts on spatial planning
- development of parcellation and other geodetic studies of the land cadaster

Roundabout in Sv. Helena (2012)

- Main and detailed design
- development of specific geodetic basis for the purpose of developing documents and acts on spatial planning

Local road LC31099 Malogorička road (2013)

- Reconstruction, obtaining location and building permit
- development of parcellation and other geodetic studies of the land cadaster

County road section : border of Zagreb – Šćitarjevo – Bukevje – Veleševac – border with Sisak county (2013)

- development of specific geodetic basis for the purpose of developing documents and acts on spatial planning
- designing

TOWN OF SISAK

Parking at primary school Viktorovac (2012)

- Idea, main and detailed design
- development of specific geodetic basis for the purpose of developing documents and acts on spatial planning
- development of parcellation and other geodetic studies of the land cadaster

SPECIAL HOSPITAL “NAFTALAN”

- preliminary architectural project of upgrading
- existing Special Hospital for Medical
- rehabilitation and complex of indoor and
- outdoor swimming pool with necessary traffic
- infrastructure
- development of specific geodetic basis for the purpose of developing documents and acts on spatial planning
- development of parcellation and other geodetic studies of the land cadaster

CROATIAN ROADS Ltd

State road D29 Novi Golubovec – Mače (12,53km, 2013)

- development of specific geodetic basis for the purpose of developing documents and acts on spatial planning
- development of parcellation and other geodetic studies of the land cadaster

State road D24 section Zlatar Bistrica – Galovec (10,1 km, 2013)

- Geodesy project

State road D35 , Section Novi Golubovec

- Reconstruction of state road and obtaining location and building permit
- development of specific geodetic basis for the purpose of developing documents and acts on spatial planning
- development of parcellation and other geodetic studies of the land cadaster

CROATIAN RAILWAYS INFRASTRUCTURE

Railway line L201 Varaždin- Ivanec- Golubovec (railway station CerjeTužno and Lepoglava)

- development of specific geodetic basis for the purpose of developing documents and acts on spatial planning
- technical documentation for energetics and outdoor lighting

UNDERGROUND GAS STORAGE OKOLI

- development of parcellation and other geodetic studies of the land cadaster
- geodesy elaborate of constructed state
- development of specific geodetic basis for the purpose of developing documents and acts on spatial planning

SHOPPING CITY ZAGREB (WESTGATE)

Junction Bistra on motorway Zagreb-Macelj

- Geodesy elaborate
- development of parcellation and other geodetic studies of the land cadaster

VIAFACTUM LTD

County road ŽC5166 on section Sveti Rok (DC50) over Mali Alan to Obrovac (DC54) 38km

- Special geodetic line for the purposes of designing

Traffic studies



The aim of the traffic study is to determine the needs and possibilities of development of the transport system and the definition of the planned road network in a particular area.

Based on this transport system solutions are made:

- modes of transport, roads, reconstruction, additi-

ons and new roads, intersections, parking lots, tourist traffic

- analysis and suggestions for improvements of public transport
- predict the optimum stages in the construction work processes

Ivanić Grad

- Traffic study – regulation – cadastre of traffic
- Traffic regulation and cadastre of traffic on the county roads ŽC 3041, ŽC 3122 and ŽC 3123 on the area of the city of Ivanić Grad
- Traffic study – regulation – cadastre of traffic of the city of Ivanić Grad
- energetic efficiency of the street lights system in Ivanić Grad

Novaki

- study on the construction justifiability for the overpass on the highway Jankomir – Bregana in Novaki at the km 3+170,00

Samobor

- regulation project and traffic flow management in the central area of the city of Samobor

Vukovar

- Vukovar port – environmental impact assessment of road traffic

Varaždin

- shopping centre Varaždin Retail Park

Zagreb

- Maksimir – study of traffic situation and a proposal for marking and organization of parking spots on areas around the Maksimir stadium.

- Pantovčak – study of traffic situation and a proposal for marking and organization of parking spots on areas around the Pantovčak street

Buzin

- traffic analysis of the business and retail zone Buzin

State Road D8

- Space and traffic analysis of the possibilities of connection the tunnel Sv. Ilija – Biokovo and the state road D8

Krapinsko-Zagorska State

- basic traffic research

Zagrebačka State

- basic traffic research





Projects of construction

of toll payment stops and border crossings and payment processing for tolls

Payment stops and border crossings

Project of the traffic signalization for the border crossing consists of regulation and leading traffic flow on traffic areas of border crossings, changeable, light changeable and constant traffic signalization and equipment.

Project comprises changeable traffic signalization on top of the border crossing/toll payment stop, light warning signalization (blinkers on concrete protection heads, portals and traffic signs) as well as electro installations of the traffic signalization, signals on the road under the top of crossings/stops and pre-signalization (portals) video-surveillance on the route of the high-

way. Traffic signalization has the function of informing the driver about the border crossing/toll payment stop, guiding certain vehicle categories to the certain control lane of the border crossing/toll payment stop. Due to this, the above stated traffic signalization has to be clearly visible and unambiguous in its message. Video surveillance informs about the current state of traffic on the road.

This project also provides for setting the traffic areas of the border crossing/toll payment stop for safe, unambiguous and simple running of the traffic.



Payment stops

- Most Krk
- Baderna
- Bisko
- Bregana
- Breznički Hum
- Brinje
- Donja Zdenčina
- Goričan
- Ivanić-Grad
- Kanfanar
- Karamatić
- Komin
- Medaki
- Novigrad
- Slavonski Brod-Zapad
- Šestanovac
- Vrbovsko
- Vrgorac
- Ivanja Reka
- Lučko
- Sv. Helena
- Zagreb – Istok
- Zaprešić
- Svilaj

- Đakovo
- Čepin
- Osijek
- Sudaraš

Border Crossings

- Goričan
- Trnovec
- Bregana
- Pribanjci
- Bajakovo
- Klek
- Bistrina
- Erdut
- Macelj
- Metković
- Luka Ploče
- Batina

El. installation

- Vinjani Gornji
- Dvorine
- Aržano Pazar
- Bili Brig
- Podpolog



Payment processing for tolls

Toll payment processing systems on the highways are open and closed.

On the road objects (bridges, tunnels) and on shorter highway routes the open toll payment system is applied. In this system, the toll payment stop serves both for entry and exit, so the payment is done immediately, according to the vehicle category. In the closed toll payment system every user has to register as a user at the entry of the highway system, and at the exit, they have to pay. In the closed toll payment system there are several entries and exits and the amount of the toll depends of the highway route length.

Principal tasks of the toll payment system are:

- calculating the amount of the toll payment, processing the data and keeping accounting records of the register debt for a particular route.
- controlling the accuracy of the toll payment by the means of video surveillance of every traffic lane
- processing the data on vehicles passing through the toll payment stops, cashiers and ways of payment, on the functioning of the system and the other data, necessary accounting records, as well as writing special reports in the control central,
- monitoring the functioning of the complete toll payment system for data collecting, with making all the necessary reports, following the customers, staff cards, archiving the data and similar.

Payment Processing for Tolls

- Demerje
- Svilaj
- Blato na Cetini
- Čepin
- Donja Zdenčina
- Đakovo
- Jastrebarsko
- Križ
- Novigrad
- Osijek
- Ravča
- Rugvica
- Slavonski Brod – Istok
- Slavonski Brod-Zapad
- Spačva
- Šestanovac
- Velika Kopanica
- Vučevica
- Županja
- Bregana
- Karamatići
- Lipovac





Algorithms and Scenarios

The purpose of making an Elaborate of Scenarios and Algorithms /course diagrams/ possible actions for remote control traffic operating is the planned preparation of software and hardware equipment, as well as the operating staff COKP-a for fast and effective operation in case of specific event in the tunnel. Scenarios comprise anticipated events in regular functioning and out of ordinary (accidental) situations. Scenarios of accidental situations are made individually for each particular fire zone in the tunnels. Algorithms /course diagrams/ are made individually for every fire zone. Algorithms work in the following way: the operators wait for a signal which would prompt some reaction by the algorithm, or a signal by operators, after which the scheduled scenarios are started. The company providing the system is obliged to implement the provided scenarios and al-

gorithms into the integration software which will control and manage the traffic-information system (PIS), video surveillance and managing system, remote control operating and monitoring (SDUN), fire alarm system, SOS system and radio fusion system with its projection on the integration video wall.

Scenarios and algorithms /course diagrams/ are divided into 4 main chapters, each of which containing a determined number of particular scenarios:

1. Scenarios and algorithms of regular operating
2. Scenarios and algorithms of possible failures
3. Scenarios and algorithms of possible accidental situations
4. Scenarios and algorithms of maintenance

AC A1 Zagreb – Split – Dubrovnik

- tunnels: Mala Kapela, Saint Rok, Bisko, Crna Brda, Stražina, Zaranač

D532 Zagvozd – Baška Voda

- tunnel Saint Ilija

AC A6 Bosiljevo – Rijeka

- tunnels: Saint Marko, Veliki Gložac, Rožman brdo, Čardak, Pod Vugleš, Javorova kosa, Vršek, Lučice, Sopač, Sleme, Vrata, Tuhobić, Hrasten

Traffic junction Rijeka City

- tunnels: Trsat, Katarina, Škurinje I, Škurinje II

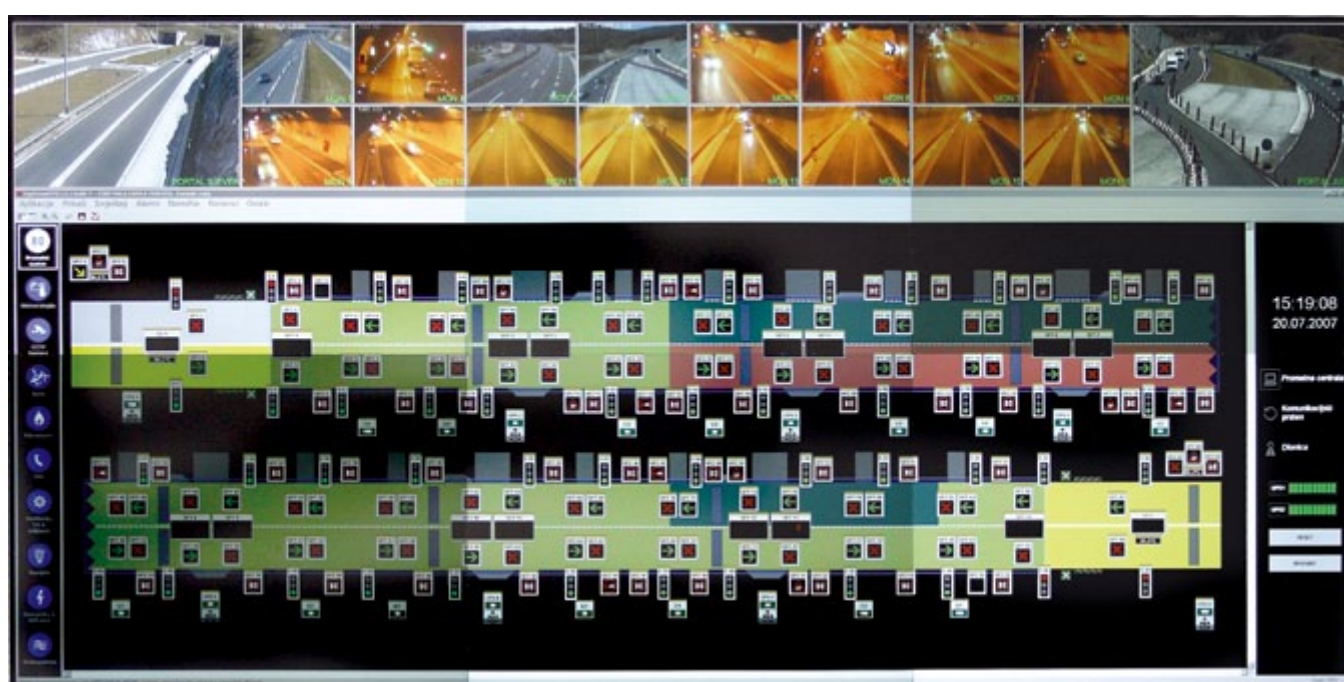

Traffic lights



Light signalization solution includes making of signalling programs based on capacity analysis and traffic counting, budgeting protection interims, making coordination diagrams, solution for the announcing sensors for detection and counting, connecting to the Traffic Center system.



Kutina

- Reconstruction of the Helešy intersection

Sesvetski Kraljevec

- Pedestrian crossing on the intersection highway road 1/3 – Školska street
- Intersection highway road 1/3 – Končareva – Lole Ribara st.

Stubičke Toplice

- Intersection Strmečke – st. Ljube Babića – Đalskog
- traffic lights installation at the intersection D307 i Ž2211

Zabok

- Intersection Matije Gupca; by the fire station

Highway Road M1/3 Zagreb – Bjelovar

- route Kraljevečki Novaki – Sesvetski Kraljevec;
- intersection Dugoselska st. to intersection with Dumovečka st. ; intersections pedestrian crossing MC1/3 in stac. 0+680,00 ; intersection Cerska – Bedem ljubavi; intersection Željeznička – Školska; intersection S. Tomerlina – Gundulićeva ulica; intersection Popovečka – Kvarnerska;

Raskrižje Budinečki put – gas station Antunović

Ivanić Grad

- intersection Savska – Ul. Kralja Tomislava
- intersection M. hrvatske – S. Fabijančića Jape – Trg P. Krešimira VI
- intersection state road D43 and local road 31177 (Majdekova street)
- pedestrian crossing in Školska on two locations
- pedestrian crossing in Caginec
- intersection Savska i Tomislavova;

Varaždin

- intersection Zagrebačke – Prešernove
- traffic light by the gas station
- south-west bypass road of the city of Varaždin, route Hrašćica – Nedeljanec, intersections Hrašćica and Nedeljanec east bypass road of the city of Varaždin; installing traffic lights on two intersections on 510 (VR1 i VR2)
- junction road from the junction Varaždin

Bjelovar

- intersection Josipa Jelačića – trg hrvatskog sokola – šetalište I. Lebovića

- intersection I. Mažuranića – šetalište I. Lebovića – Franjevačka st.
- KOPRIVNICA;
- reconstruction of a part of the street P. Miškine

Express Way Zagreb – Bjelovar

- route Sv. Helena – Vrbovec

HW Zagreb – Varaždin – Goričan

- route Popovec – Komin; sub-route Sv. Helena – Komin

Zagreb

- intersection Jarunska – Haberleova street
- intersection Voćarska road – Vončinina street
- intersection Ivanićgradska – Zapoljska street
- installing additional traffic lights at the intersection "Av. Dubrava – Dankovečka – Vinodolska"
- installing additional traffic lights at the intersection "grada Vukovara street – Ivanićgradska street"
- installing additional traffic lights at the intersection Slavonske – M. Čavića
- project of pre programming of the traffic light device "Čvor Jarek"



- installing additional traffic lights at the intersection "Čulinečka road – Street Badema"
- proposal of installing traffic lights at the intersection of Savska i Koturaška street near the elementary school Tin Ujević
- installing additional traffic lights at the intersection "Sv. Mateja – Kauzlarićev prilaz"

Soblinec

- pedestrian crossing

Samobor

- reconstruction of city roads, intersection street A. Starčević – Betonska street

Čakovec

- south bypass road of the city of Čakovec; raskrižje "B"; raskrižje "C"; raskrižje "E"
- intersection of the ZAVNOH street

Express Way Mostanje – V. Cerovac

Ražine

- reconstruction of intersection DC-8 i LC-65060

Velika Gorica

- intersection at the Kralja Petra Krešimira IV Square – by the market
- intersection st. Slavka Kolara – st. A. Kačića Miošića
- in front of the building of the City Council, by the restaurant Park and in Kolodvorska street
- installing traffic lights at the intersection of Slavka Kolara street in Velika Gorica – intersections with Gajeva st., N. Tesla street and bana J. Jelačića street

Novi Marof

- reconstruction of state road D3 route IV through Novi Marof pedestrian crossing marking

Ludbreg

- intersection of V. Nazora st, Petra Zrinskog i M. Gupca st.

Osijek

- west bypass road of Osijek; intersection D7 and Strossmayerova st.

Odra

- protection of the pedestrian crossing

Galdovo

- protection of the pedestrian crossing

Novska

- protection of the pedestrian crossing

Breštača

- protection of the pedestrian crossing

Splits

- branching of Vukovarska – route 1
- branching of Vukovarska – route 2
- Kavanjinova Street
- Bihačka Street
- Manderova Street
- intersection of Vukovarska and entry to Sućidar
- intersection of Brune Bušića and Šižgoričeva
- intersection of Vukovarska and Lovrinačka
- intersection of Lovrinačka and Lovački put
- reconstruction of D8 – Split bypass road; sub-route Stobreč-Strožanac
- reconstruction of D8 – route Solin-Kaštel Sućurac
- Split bypass road; Stobreč intersection
- installment of traffic lights on Matoševa – Prilaz V. Nazora – Rendićeva
- roads with infrastructure by the garage-business center "Small Mall"

Kloštar Ivanić

- intersection of state roads 3041 and 3074

Highway A10 Border Crossing with Bosnia and Herzegovina – Mali Prolog – Ploče

- route Mali Prolog – Ploče; sub-route ČCP Karamatići – Ploče; junction road

Sesvetski Kobiljak

- reconstruction of the streets Bjelovarska, Popovečka and Kvarnerska
- reprogramming of traffic lights on the intersection 'Bjelovarska – Popovečka – Kvarnerska'

Vodice

- introduction of street lights regulation on the pedestrian crossing nearby the A. Šenoa Street

Sisak

- introduction of street lights on the intersection 'Stari most – connection road' on the km 0 + 379.39
- construction of the southern and the reconstruction of the northern road of the state road D36 in Sisak, Zagrebačka street, intersections 'A' and 'B'

Prkos Ivanički

- protection of the pedestrian crossing at the bus station

Brdovec, Laduč and Šenkovec

- introduction of street lights on three pedestrian crossings

Street lights



Project of installment of street lights entails the classification of every street based on the intensity of traffic load (Classification of the Lighting Situation EN 13201), the suggestion of measures necessary for energy efficiency, technical estimates for LED substitute lamps,

design and specification of cable channeling for the electroenergetic network for street lights power supply, street lights posts, choice of power supply cables and lights (LED technology).



Ivanić Grad

- reconstruction of city roads Krešimira IV; Pokupska; Maznica
- UPU-3, business zone in the Ivanić-Grad area,
- UPU-6, business zone in the Ivanić-Grad and Caginec area

Velika Gorica

- Projects of relocation of street-lights

County of Križ

- Auxiliary road and all the corresponding infrastructure

Ploče

- access terminal of the Ploče port

Express Way Vrbovec – Bjelovar

- from km 6+250,00 to km 27+530,00 (stage 2, 3 and 4)

ČCP Ivanja Reka

- Projects of street-lights

Highway A3 Bregana – Zagreb – Lipovac

- intersection Novska
- intersection Popovača – rationalization of the traffic lights system

Highway A1 Zagreb – Split – Dubrovnik

- reconstruction of the access to the toll payment stop Lučko from the direction of Karlovac

Highway A13 Vrbovec – Bjelovar

- Intersection Frakaševac, Intersection Kapela, Intersection Gudovac

NP Lučko and ČCP Lučko

Highway Kosovo

- Route: Morine – Merdare





Guidelines and Croatian Standards

The company ZG-PROJEKT d.o.o. has been active in the regulatory process related to traffic from the very beginning.

MINISTARSTVO MORA, TURIZMA, PROMETA I RAZVITKA

Na temelju članka 31. stavka 2. Zakona o sigurnosti prometa na cestama ("Narodne novine", br. 105/04) ministar mora, turizma, prometa i razvika u suglasnosti s ministrom unutarnjih poslova donosi

PRAVILNIK

o prometnim znakovima, signalizaciji i opremi na cestama

1. OPĆE ODREDBE

Članak 1.

Ovim se Pravilnikom propisuju vrsta, značenje, oblik, boja, dimenzije i postavljanje prometnih znakova, signalizacije i opreme na cestama.

Članak 2.

Prometne znakove, signalizaciju i opremu cesta čine:

1. prometni znakovi, i to:
 - znakovi opasnosti;
 - znakovi izričitih naredbi;
 - znakovi obavijesti;
 - znakovi obavijesti za vođenje prometa;
 - dopunske ploče;
2. prometna svjetla i svjetlosne oznake;
3. oznake na kolniku i drugim površinama;
4. prometna oprema cesta, i to:
 - oprema za označavanje ruba kolnika;
 - oprema za označavanje vrha prometnog otoka;
 - oprema, znakovi i oznake za označavanje radova, prepreka i oštećenja kolnika;
 - svjetlosni znakovi za označavanje radova, drugih zapreka i oštećenja kolnika;
 - oprema za vođenje i usmjeravanje prometa u području radova na cesti, prepreka i oštećenja kolnika;
 - branci i polubranci;
 - prometna zrcala;
 - zaštitne odbojne ograde;
 - ograde protiv razdijeljivanja;
 - zaštitne žičane ograde;
 - pještice ograde;
 - ublaživači udara;
5. signalizacija i oprema za smirivanje prometa;
6. turistička i ostala signalizacija propisana je posebnim propisima.

Članak 3.

Na prometnom znaku natpis se ispisuje latiničnim pismom. Natpisi na znakovima obavijesti, u pravilu, se ispisuju malim slovima. Dvojezični nazivi odredišta moraju biti napisani tako da je prvo napisan hrvatski naziv, a potom naziv na jeziku i pismu nacionalne manjine ako je to propisano posebnim propisom. Na prometni se znak može upisati i naziv odredišta koje se nalazi u drugoj državi. Naziv odredišta u drugoj državi ispisuje se na jeziku te države. Uz odredište u drugoj državi obavezno se upisuje znak obavijesti C123 (nacionalna autocesta).

Članak 4.

Prometni znakovi izrađuju se tako da je njihovo značenje stalno ili promjenljivo. Površina prometnih znakova izrađuje se od materijala retroreflektirajućih svojstava najmanje klase I, a za autoceste i ceste namijenjene isključivo prometu motornih vozila - bez ceste, najmanje klase II. Boja polodne podloge znaka mora biti sive boje i bez sjaja.

kako bi se vozila smirila i održavala sigurnost

Prometni

svjetlosti (umut

Prometni;

biti izvedeni sa

Na signal

označavanje ra

usmjeravanje i

ograda na ma

minimalno klas

Prometni i

izrađeni i post

Prometni i

se na temelju p

Za postavl

ovog članka po

Prometni i

istih retrorefle

Dopunske

znaka kojima s

koj se postav

Prometni i

smjeru kretanja

Ako na tr

opasnost da g

gustoće promet

na suprotnoj, li

Prometni i

vozila i pješa

Prometni i

visini 1,2 do

obilježanje) ka

privoj), C75 i

medunarodne o

državne ceste),

oznaka za auto

cesti i C123 (e

visini 80 do 12

Prometni i

na visini 0,30 d

postavljaju se n

Visina az

kolnika do don

postavlja zapti

dopunske ploče

da ne ugrozav

zaklanjaju.



Zagreb, 2005.

N.N. 33/2005
N.N. 64/2005
N.N. 155/2006



Znak B06

7) znak "zabrana prometa za teretne automobile" (B07) označuje cestu, odnosno dio ceste na kojem je zabranjen promet teretnim automobilima. Ako je znaku ispod simbola kamiona upisana najveća dopuštena masa kamiona, zabrana vrijedi samo za one teretne automobile čija najveća dopuštena masa premašuje označenu;



Znak B07

8) znak "zabrana prometa za cisterne" (B08) označuje cestu ili dio ceste na kojem je zabranjen promet vozilima koja prevoze tvari koje mogu zapaliti okoliš. Od toga je izuzeto pogonsko gorivo u spremniku ako spremnik ispunjava uvjete ECE.

ovina s kotlačima, odnosno te crte plave su boje;

koja prevoze eksploziv ili cestu, odnosno dio ceste na a prevoze eksploziv i neke novina vozila i kotači crne

koja prevoze opasne tvari" na kojoj je zabranjen promet novina vozila i kotači crne



Znak B10

11) znak "zabrana prometa za sva motorna vozila koja vuče priključno vozilo" (B11) označuje cestu ili dio ceste na kojoj je zabranjen promet za sva motorna vozila koja vuče priključno vozilo;



Znak B11

12) znak "zabrana prometa za teretni automobil koji vuče priključno vozilo" (B12) označuje cestu ili dio ceste na kojoj je zabranjen promet za teretni automobil koji vuče priključno vozilo;



Znak B12

13) znak "zabrana prometa za traktore" (B13) označuje cestu ili dio ceste na kojoj je zabranjen promet traktorima;



Znak B13

14) znak "zabrana prometa za motocikle" (B14) označuje cestu ili dio ceste na kojem je zabranjen promet motociklima i motornim vozilima na tri kotača. Simbol znaka može biti i u obliku motornog vozila sa pogonom na tri kotača;



Znak B14

Guidelines for selective speed limit on public roads in inhabited areas

Technical measures for traffic regulation from the viewpoint of traffic – practical guidelines

Guidelines for remote management of traffic

Traffic signs, equipment and road signalisation directives

Croatian standards for traffic signalisation

Croatian standards for traffic lights and guidelines for their application in practice

Traffic signs, equipment and road signalisation directives

Technical Conditions for Construction Works on Highways TU – 2007 – Book VI: Highway Equipment

HRVATSKE CESTE d.o.o.

PRIMJENA PROMJENLJIVIH ZNAKOVA NA AUTOCESTAMA I BRZIM CESTAMA (Smjernice)



Zagreb, 2002.

Sanation of dangerous sites



Sanation of dangerous sites on road with traffic signalisation and equipment used to slow down the traffic – speed bumps and elevated surfaces.

HW of Karlovačka, Brodsko-Posavska and Zagrebačka counties – four dangerous sites

- Laze, Nova Kapela, Josipdol and Popovec

Equipment for slowing down traffic – bumps

- Sv. Nedelja, Ivanić Grad, Lomnica, Donja Lomnica, Šćitarjevo, Velika Mlaka, Pisarovina and Bratina, Bregana (Jelačićeva), V. Rakovica, Molvice, Rude, Manja Vas, Sveti Martin

State road D1

- Karlovac; intersection of expressway and Kralja Tomislava street
- Karlovac, route 010 junction Karlovac – Krnjak intersection Smičiklasova – Holjevnice
- route Pećani – Jošani

State road D7

- reconstruction of D7 Beketinci

State road D20

- route Čakovec – Nedelišće

State road D33

- Knin; Elementary School Knin 2
- Eminovci, route Gradište – Požega

State road D37

- route Sisak – Petrinja

State road D121

- Tisno; location within the area of the elementary school “Tisno”

State road D410

- route 001 Split ferry port – Split D8
- intersection D410 and Velebitska street Split

Sanitation of dangerous sites

- Žudetici, Putičanje, Laz, Buzin, Srebreno, Ogulinec, Karlovac – Smičiklasova, Imotski, Krpan, Dubac, Sveta Nedelja, Makojišće Gornje, Čiovo, Pula, Jelaš – Cerovac, Hrvatski Blagaj – Pavlovci, Gutešino Vrelo, Velika Kopanica – Vrpolje, Sračinec – Majerje, Veliki Zaton, Novi Vinodolski, Sveti Filip i Jakov, Šibenik, Ražine, Kaštel Lukšić

Crnica

- city road in Šibenik, zone of J. Dalmatinca elementary school

Šibenik

- Brodarica; junction of Kamenita street and Adriatic Highway





International projects

Beside having great experience in the development of traffic and technical documentation, we are also present on the international market: precisely, on the markets of

Montenegro, Bosnia and Herzegovina and Serbia, where we are equally successful in traffic and technical projects related to highways, expressways, state roads and other.



MONTENEGRO

HW Đurmani – Tanki Rt (5 km)

- semi- highway
- ČCP Gluhi dol
- temporary connection to Sutomore
- temporary connection to Virpazar
- semi- highway – regulation of traffic in one lane

HW Podgorica – Mateševo (28 km)

- route Veruša – Mateševo
- route Uvač – Mateševo

Beltway of Kotor (3 km)

- route around the old town

Express way along the coastal part of Montenegro (96 km)

KOSOVO

HW Morine – Merdare (89 km)

- Section 1,2,3 and 9
- Traffic equipment and signalization

- Street lights

BOSNIA AND HERZEGOVINA

HW VC corridor Svilaj – Southern border of BiH (60 km)

- LOT4 (0+000 – 8+800)
- LOT4 Mostar North – Mostar South (9+800 – 26+300)
- LOT4 (26+300 – 45+900)
- LOT4 (58+000 – 45+900)

SERBIA

HW Horgoš – Beograd (172,87 km)

- Route: from km 1+125 to km 70+400 (junction Horgoš, junction Subotica North, junction Subotica East, junction Subotica South, junction Čantavir, junction Bačka Topola, junction Mali Idoš, junction Feketić)
- Route: from km 70+400 to km 108+000 (junction Vrbas, junction Sirig)
- Route: from km 108+000 to km 120+000 (junction Novi Sad North, junction Novi Sad center, junction Zrenjanin)
- Route: from km 120+000 to km 174+000 (junction Kovilj, junction Gardinci, junction Beška, junction Maradik, junction Indija, junction Stara Pazova, junction Novi Banovci)





Expert designer monitoring and surveillance

Professional Supervision is carried out based on the current Croatian law and includes the control and monitoring of quality and dynamic work, the regular tour of

the site, management and control of the necessary construction documentation, resolving any problems with contractors, monitoring deadlines.



HW Zagreb – Sisak

- Section Jakuševac-Velika Gorica – Lekenik
- expert surveillance of construction works – power supply of electrical fittings, road lights, telecommunications network and traffic signalization
- Investor: Institute IGH

State road DC 510, from county road ŽC 2086 to access road on junction Varaždin

- Expert surveillance of construction works
- Investor: Institute IGH

City of Ivanić-Grad

- Expert surveillance of construction works : civil, electrical, mechanical
- Investor: Town of Ivanić-Grad

Underground storage of gas Okoli

- Expert surveillance of construction works : civil, electrical, mechanical, geodesy
- Investor: PSP Okoli Ltd

Reconstruction of the access to the toll payment stop Lučko from the direction of Karlovac

- Expert surveillance over the telecommunication and traffic signalization and equipment
- Investor: Institut građevinarstva Hrvatske d.d.

Installation of a shed in Ivanić Grad

- Expert surveillance and quality control during the installation of a shed of a total size of 14,500 m²
- Investor: Croatia – baterije d.d.

II.B Phase of the construction of the highway Rijeka – Zagreb

- Expert surveillance, quality control and inspection of the installed equipment, traffic and other equipment
- Investor: Autocesta Rijeka – Zagreb d.d.

Rijeka bypass road, route Junction Orehovica – Junction Diračje

- expert surveillance of construction works: noise protection walls, cable channeling, control of concrete
- expert surveillance and quality control of the horizontal and vertical traffic signalization and equipment
- Investor: the company Autocesta Rijeka-Zagreb d.d.

Reconstruction of substations TS 35/20 kV Kupjak

- expert surveillance of reconstruction works
- Investor: HEP Distribucija d.o.o., DP Elektroprimorje Rijeka, plant Skrad

Equipment replacement in the 20kV facility of TS 35/20 kV Door

- expert surveillance of reconstruction works
- Investor: the company Autocesta Rijeka-Zagreb d.d.

Roadside facility Tuhobić – South

- expert surveillance of construction works – power supply of KB 20 kV plug with the construction of substation TS 10 (20)/0,4 kV, water supply with ductile pipeline and access to public telecommunications network
- Investor: the company Autocesta Rijeka-Zagreb d.d.

Roadside facility Vrbovsko – North and South

- expert surveillance of construction works – power supply of KB 20 kV plug with the construction of substation TS 10 (20)/0,4 kV, water supply with ductile pipeline and access to public telecommunications network
- Investor: the company Autocesta Rijeka-Zagreb d.d.

AC A1 Zagreb – Split – Dubrovnik

- Project surveillance of highway route Doli-Osojnik
- Investor: Institut građevinarstva Hrvatske d.d.

AC A1 Zagreb – Split – Dubrovnik

- intersection Donja Zdenčina
- expert surveillance and quality control of the horizontal and vertical traffic signalization and equipment
- expert surveillance and quality control of changing traffic signalization and the toll payment processing
- expert surveillance and quality control in the construction of bearing structures
- Investor: the company Autocesta Rijeka-Zagreb d.d.

Energy certification



Contemporary energy management in buildings includes a wide analysis of all energy systems of the building with the aim of determining efficiency or non-efficiency of energy consumption and making conclusions and recommendations for increasing energy efficiency. Energy survey also includes an analysis of the state and the possibilities in relation to the implementation of measures for improvement of energy capacities of the building and increase in energy efficiency, and is a basic tool for determining the grade of energy consumption in the energy certification of buildings.

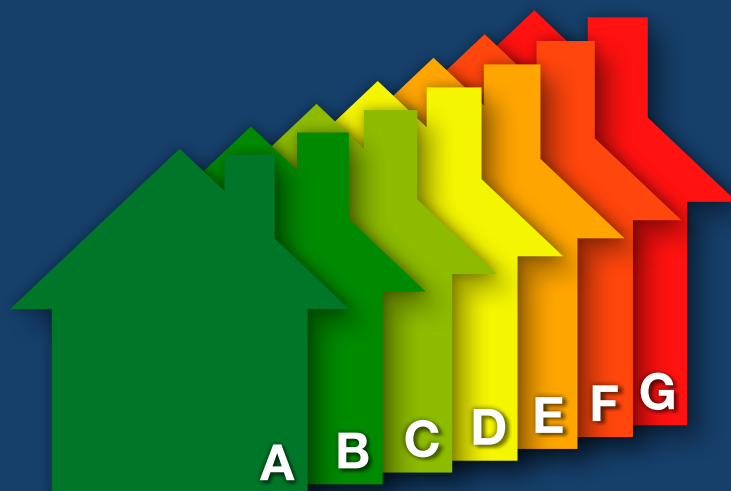

HW Zagreb – Macelj

- 2013 Energy survey of light system, buildings, energy certificate implementation of measures for improvement of energy capacities,

HW Rijeka – Zagreb

- Energy efficiency of light system design

City of Zagreb

- Energy certification of 37 kindergartens

Special Hospital Naftalan

- Energy survey on indoor and outdoor lights
- Energy certification

Municipality Velika Ludina

- Energy survey on outdoor lights



Investments



Our biggest investment, of which we are particularly proud is the condominium and office building in Ivanić Grad, Savska 102 Street. The object is characterized by modern and practical architectural design, quality materials and construction. Our building has 62 apartments, 7 offices, underground parking with storage, five lifts per floor.



CONDOMINIUM AND OFFICE BUILDING

Savska ulica 102, Ivanić-grad

- Flats: 62 flats from 48,80 m² to 100,60 m²
- Bars: 7 establishments from 42,72 m² to 316,10 m²
- Investor: ZG-project d.o.o.
- Designer: STUDIO GSG d.o.o.





ZG-projekt d.o.o.

for design and surveillance

Dorđićeva 24
10000 Zagreb

tel +385 1 48 52 214, 48 52 215
fax +385 1 48 17 973
e-mail zg-projekt@zg-projekt.hr
web www.zg-projekt.hr

